

# CHESNEY'S

Bio-Ethanol Installation & User Manual

model: EFB1200 with resevoir

Thank you for choosing this Chesney's Bio-Ethanol fire.  
Please read this information guide carefully in order to  
safely install, use and maintain your product.

# *Contents*

## Section A: Installation Guide

Installation	4
Housing configurations	14

## Section B: User Manual

I.	Safety	22
II.	Operation	24
	Operating Elements	24
	Initial start-up of the device	26
	Flame size regulation	29
	SLEEP function	30
	Extinguishing the appliance	30
	Subsequent start-up	30
	Switching off	31
	Information and warning alert	32
III.	Customer's Menu	35
	Locking the appliance	35
	Child lock	36
	Set time	37
	Device IP	37
	Remote control	38
	Fast start	39
	Serial number	39
	Software	39
IV.	Cleaning and maintenance	40
V.	Fuel	41
VI.	Disposal and recycling	41

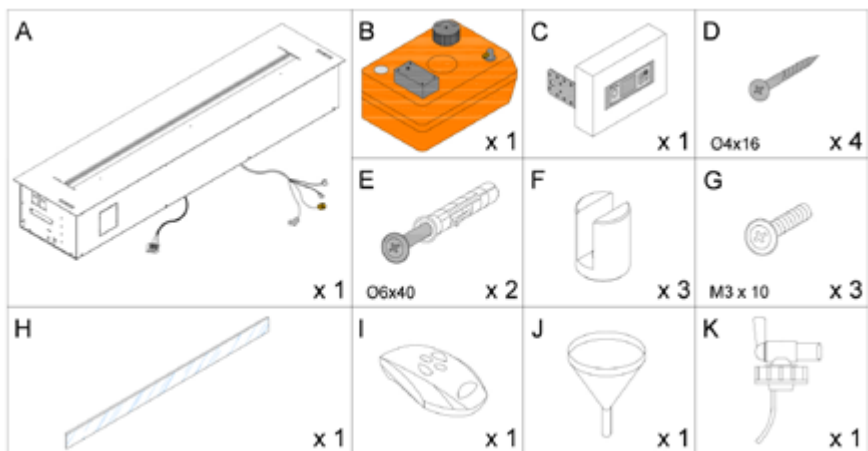

H	237mm (9 5/16")
H1	183mm (7 3/16")
H2	180mm (7 1/16")
H3	3mm (1/8")
L	1190mm (46 7/8")
L1	1000mm (39 3/8")
L2	95mm (3 3/4")
D	280mm (11")

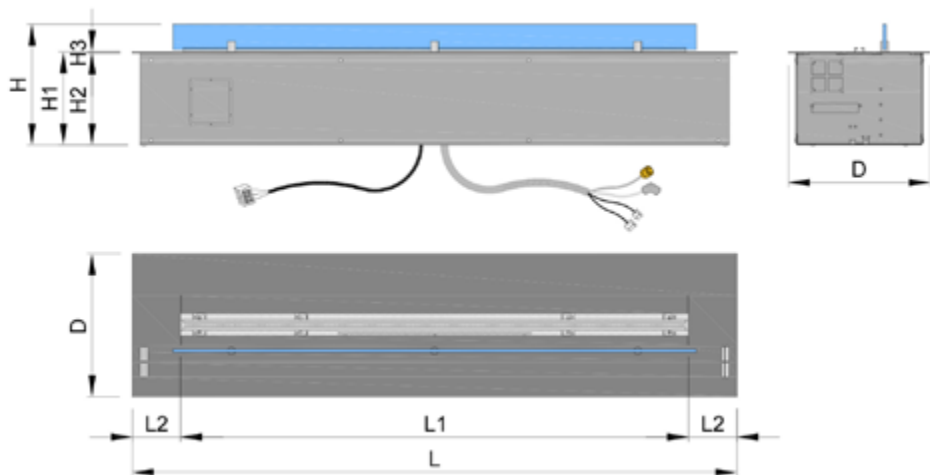

## Section A: Installation Guide



- Do not install the appliance in areas with a cubic capacity of less than 178m<sup>3</sup> / 6286ft<sup>3</sup> (68m<sup>2</sup> / 732ft<sup>2</sup> with a height of less than 2.6m / 8.53ft).
- Do not install the appliance near fans, vents or anything that can cause significant draughts of air.
- Do not place in areas where there might be a potentially explosive atmosphere of paint vapours, industrial dusts, etc.
- No flammable items should be placed in direct contact or within a radius of 1m / 3.28ft of the appliance. Do not place near curtains, net curtains, etc.
- Do not expose to external weather conditions. The product is for internal use only.
- Do not place the appliance in close proximity to sources of humidity.
- It is obligatory to have a carbon-dioxide (CO<sub>2</sub>) or dry chemical extinguisher placed nearby the appliance.
- Installation of the appliance must allow for easy removal of the appliance for servicing.
- The room in which the appliance is to be installed must have sufficient ventilation to ensure air exchange in the room at least once per hour.
- Do not start the appliance before full installation has been completed.
- Do not fill the fuel container before placing the appliance into its final position.

## INSTALLATION

**NOTE!** If you plan to operate the bio fireplace with a device that has a WI-FI connection (e.g. smartphone, tablet) please acquaint yourself with the content of the *Configuration of the module with Wi-Fi and Smart Home System* manual before installing the fireplace in the building.

- After opening the packaging box leave the device inside the box for approx. 2 hours until it reaches room temperature. During this time familiarize yourself with the user's and installation manuals.
- The elements of construction used over the appliance must be made of non-flammable materials.
- Any recess below the appliance must be sealed.
- A loose cable min. 3 x 1.5 mm<sup>2</sup>, with power supply 230V, 50Hz must be provided to connect the appliance to the mains.
- The device can be wired directly into a fused spur or alternatively a standard 3 pin 13 amp mains plug can be fitted (not supplied).
- If there is going to be a cover over the appliance, it must be made of non-flammable materials and the minimum distance from the appliance must be no less than 40cm / 15 ¾"

For reasons of safety, under no circumstances can there be any flammable material within a 1m radius of the appliance. The manufacturer does not recommend placing any heat sensitive materials or devices above the appliance as it can significantly affect the materials, properties and lifetime. The manufacturer will not bear any responsibility for the damage caused to any heat sensitive materials or devices installed above the appliance.

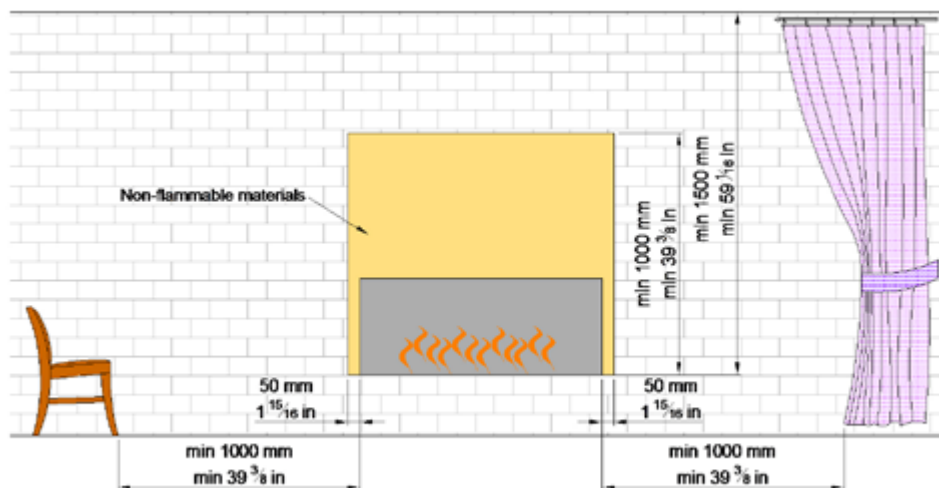
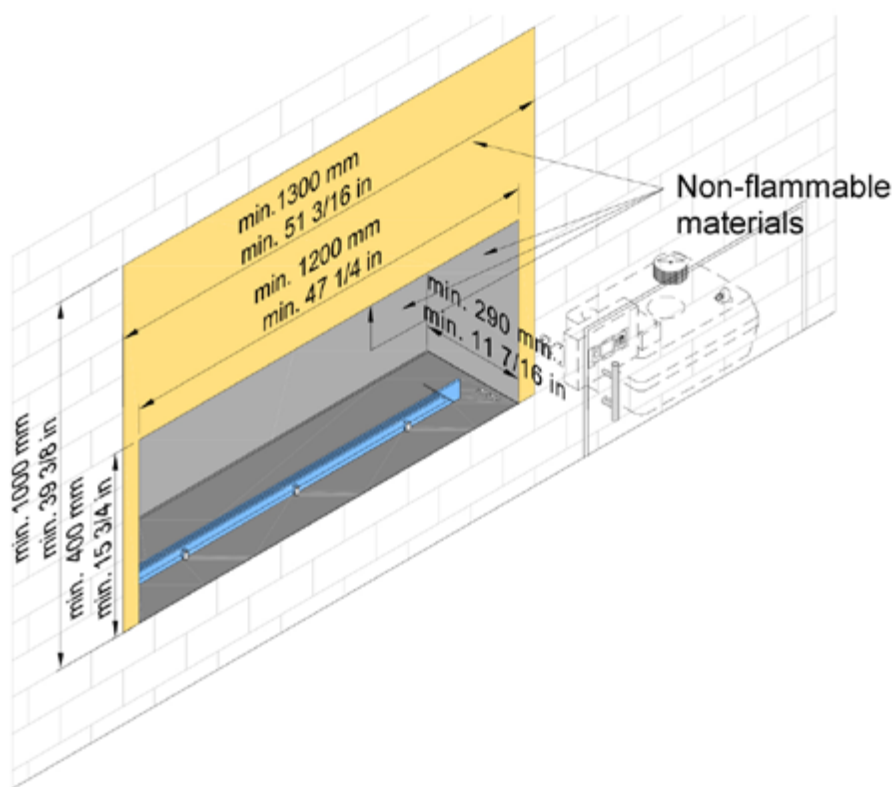

## How to construct the housing for the appliance:

Cavities need to be prepared for both the EFB1200 unit and the external tank and control panel. The cavities need to be connected by a channel with a minimum 50mm diameter.

Attention! The distance between the device 'A' and External Tank 'B' cannot exceed 1500mm. Maximum span between levels of the top of the furnace and the level of the external tank installed is 800mm.

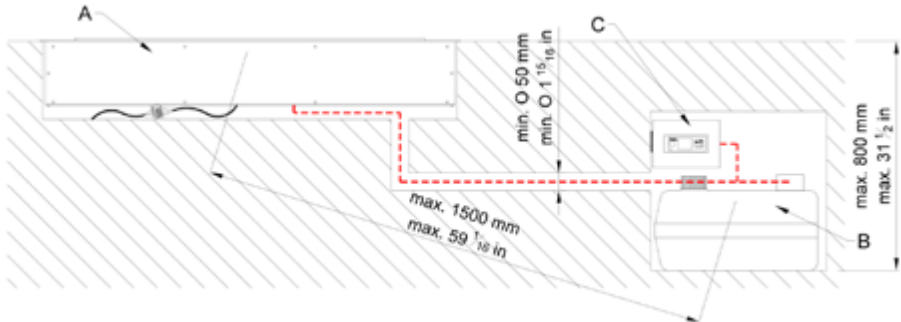

Make a cavity for the appliance following the diagram below. Ensure that the plane within the cavity on which the appliance is to be installed is level.

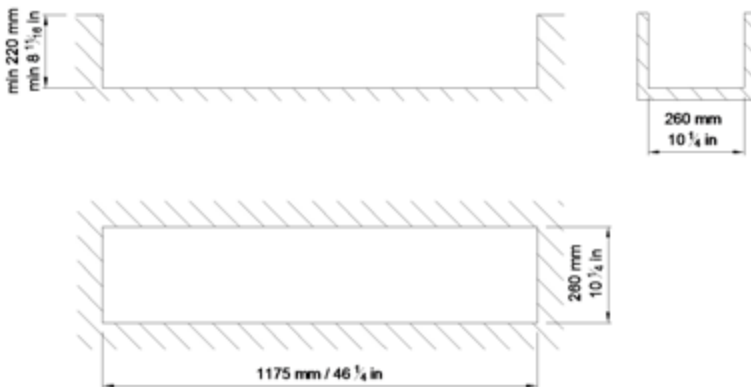

The difference in level between the ends of the appliance must not exceed 2mm. Poor levelling may cause abnormal operation of the appliance and, in extreme cases, it can cause leaks of the bio-ethanol fuel and the danger of fire.



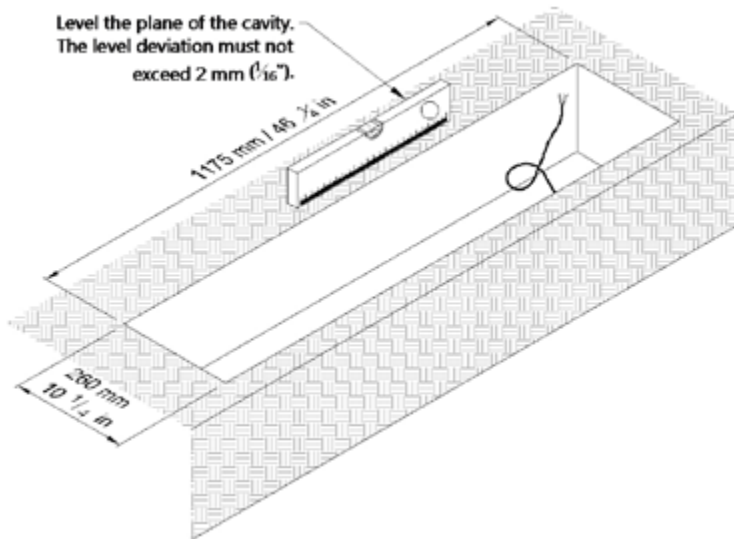

### How to prepare the housing for the external tank and control panel:

Prepare the cavities (dimensions HxLxD):

I. 350mm x 700mm x 350mm when the control panel is installed next to the external tank.

II. 450mm x 500mm x 350mm when the control panel is installed above the external tank.

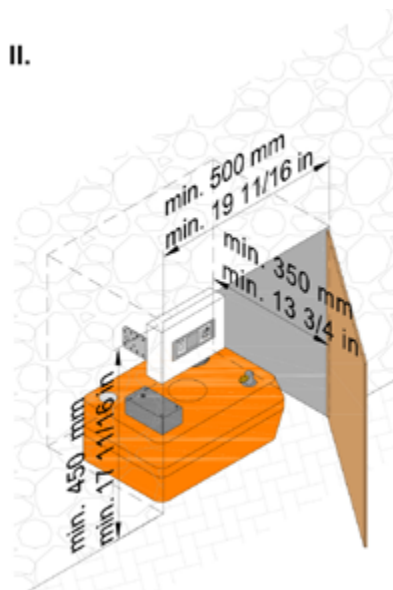
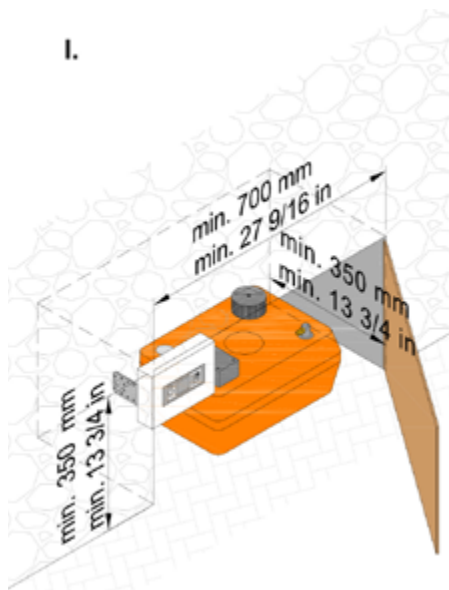

Place the external tank 'B' in the cavity and install external control panel 'C'. In order to install the control panel use four screws 'D' or two wall plugs 'E' (depending on the material).

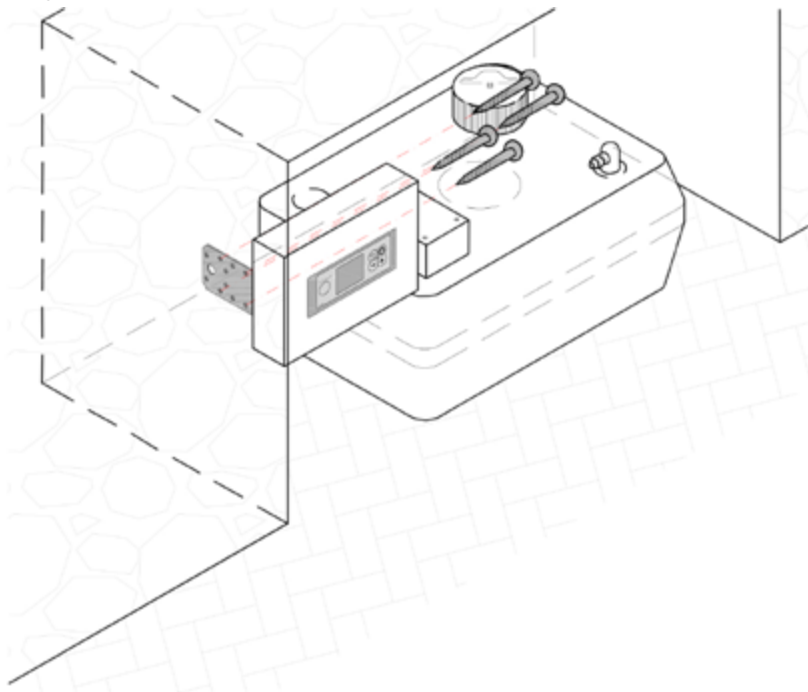

Place the cable (indicated by the arrow) in the cavity where the external tank is situated.

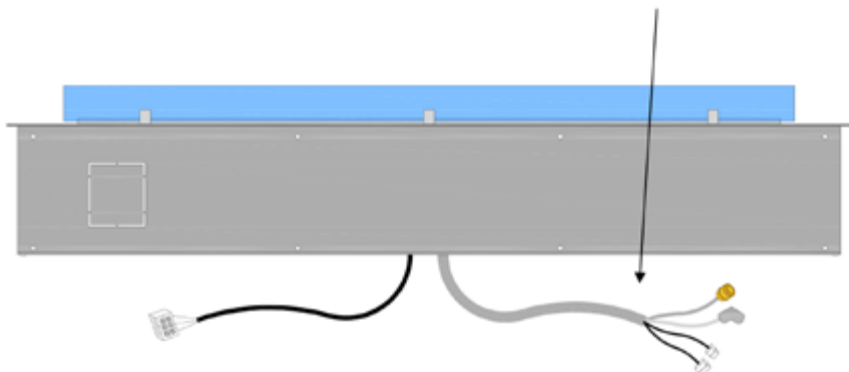

Then connect the cable to the external tank 'B':

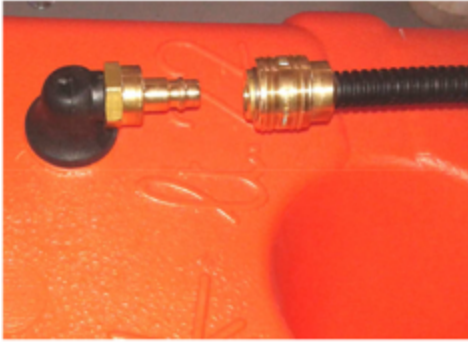

and to the external control panel 'C':



Then connect the cable supplied with a connection block at the end of the cord. Note that connection to the mains must be made by a qualified electrician.

Highlighted  button indicates proper connection of the appliance to the power supply. Once connected to the power source the appliance should be placed in the prepared cavity, by using attached handles. Please make sure to remove the handles before starting the appliance and keep them for the lifetime of the appliance. If necessary, use the handles to remove the appliance.

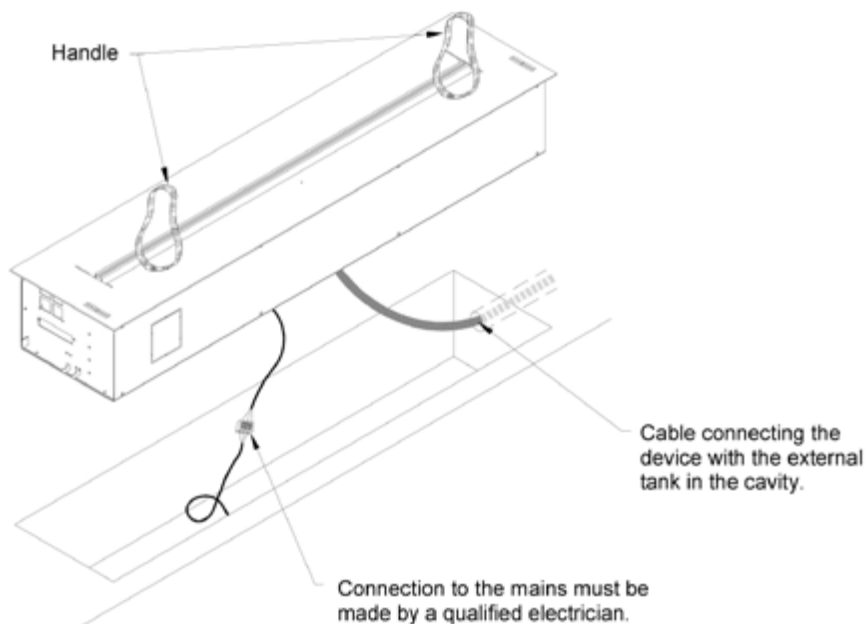

Installing the glass shield to the appliance:

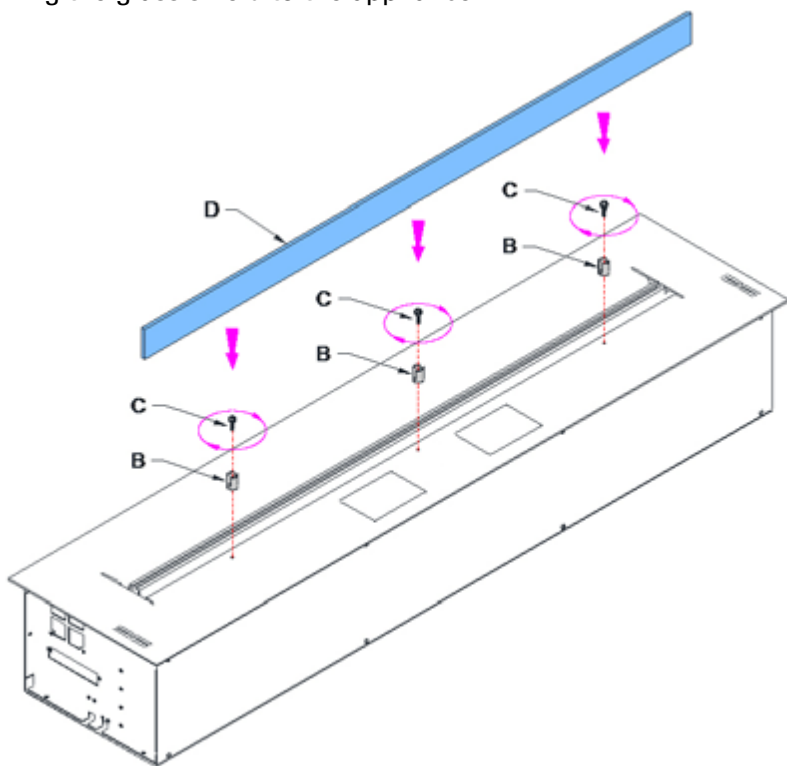

Situations where the installation of the glass shield with the appliance is necessary:

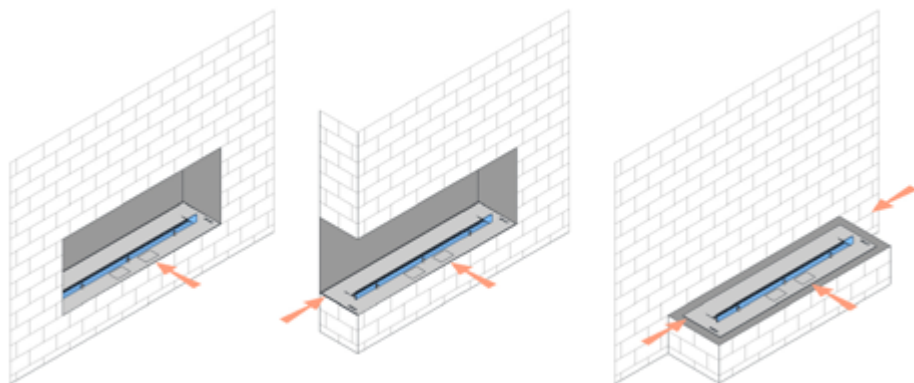

Situations in which installation of a glass shield is forbidden:

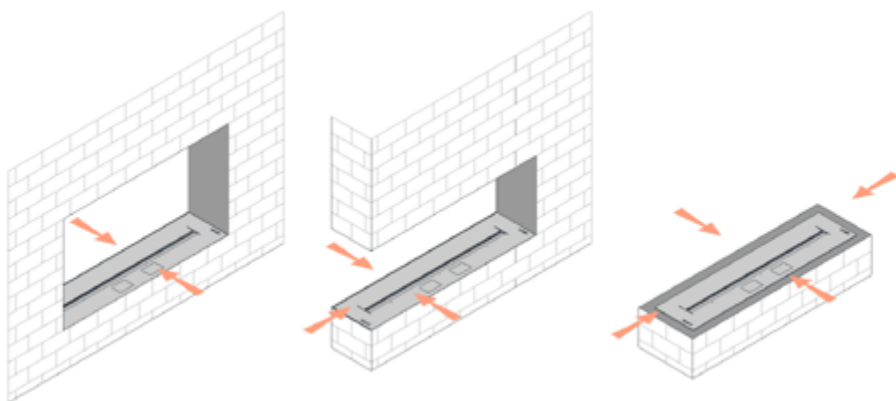

### ATTENTION!

- Make sure that the appliance has been correctly installed and read the attached instruction manual.
- You must not fill the fuel tank and start the appliance before reading the instruction manual.
- If in the future it is necessary to take the appliance out of the housing, wait until the fuel has burned-up completely and the display shows NO FUEL, disconnect the power supply and take the appliance out of its housing.
- Keep this instruction manual throughout the lifetime of the appliance.

## Guide for designing the housing for the appliance

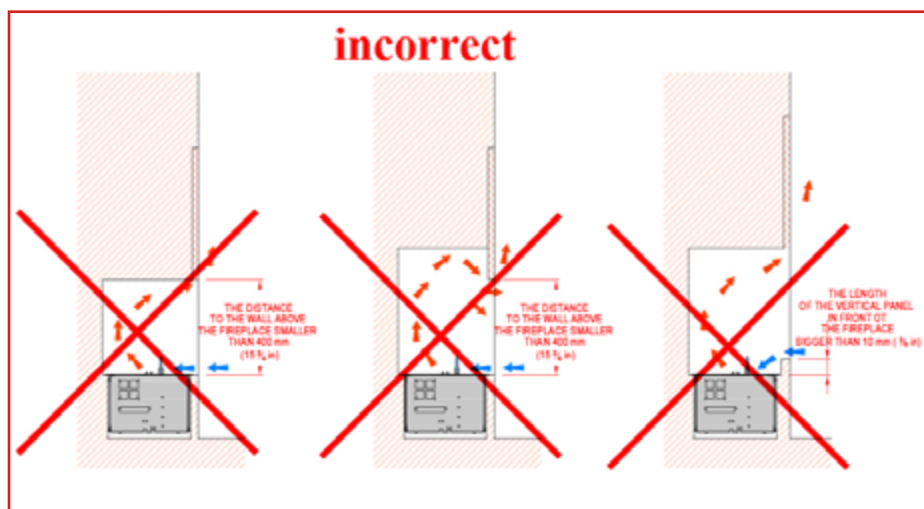
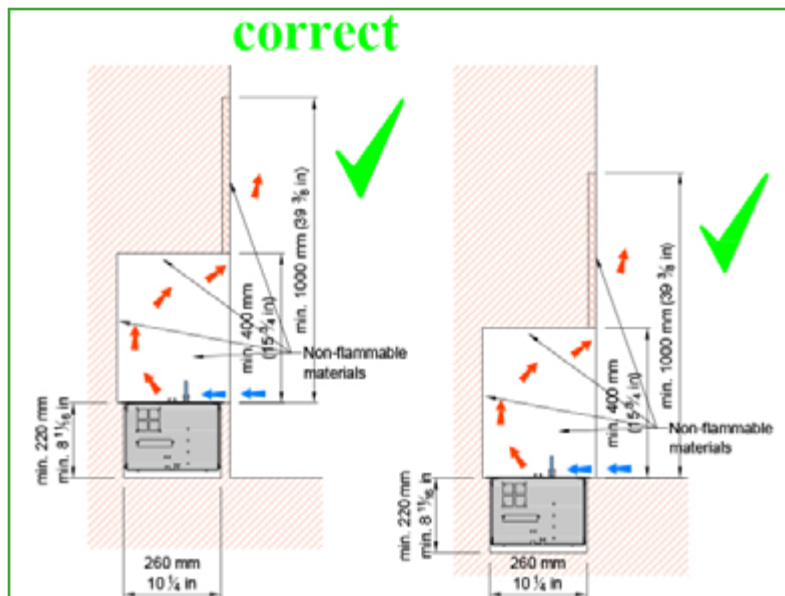

## Installing an optional glass fascia

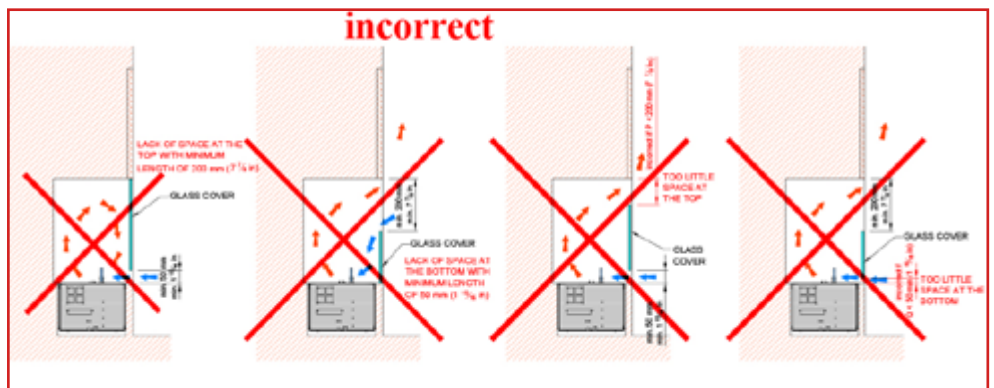
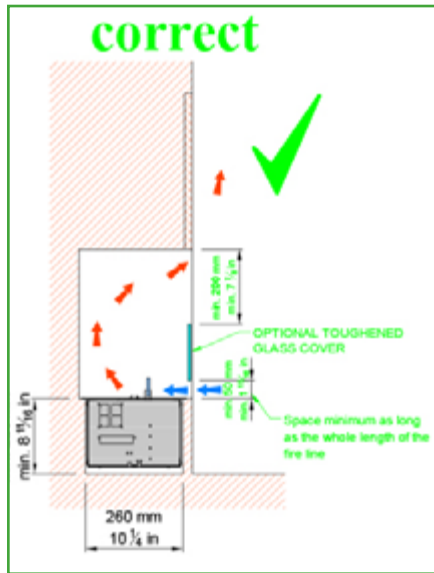



# Mounting a heat sensitive item such as a TV above the fireplace

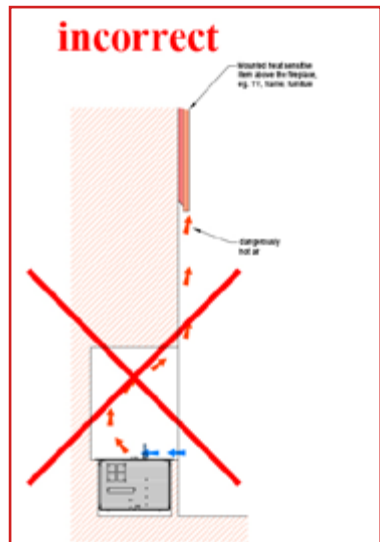
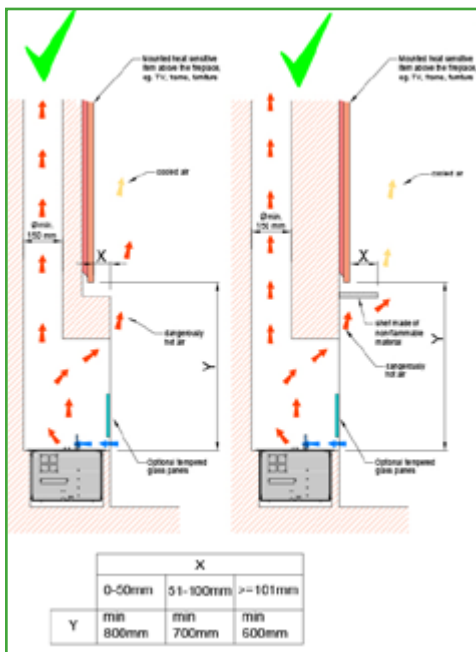
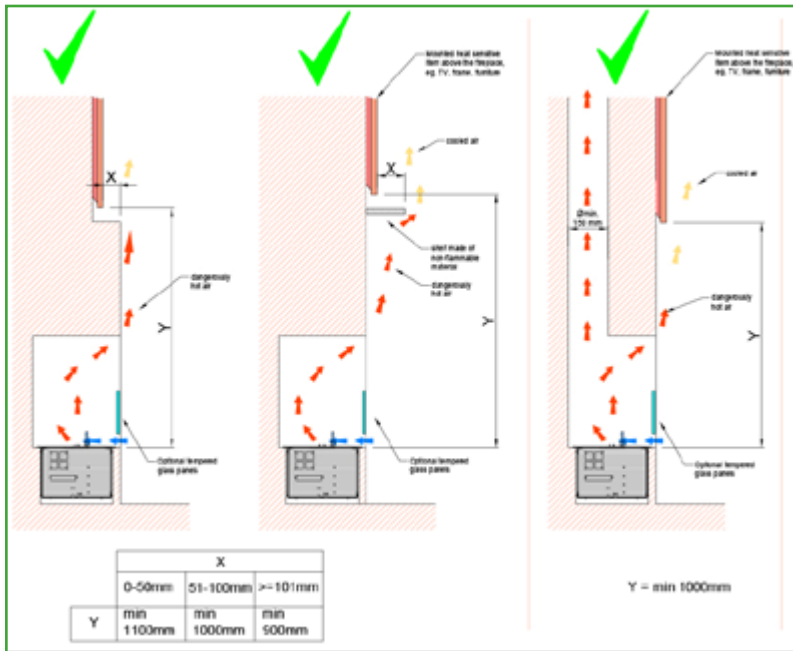

## Installation with a two sided open setting

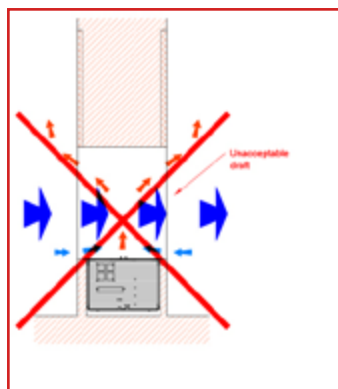
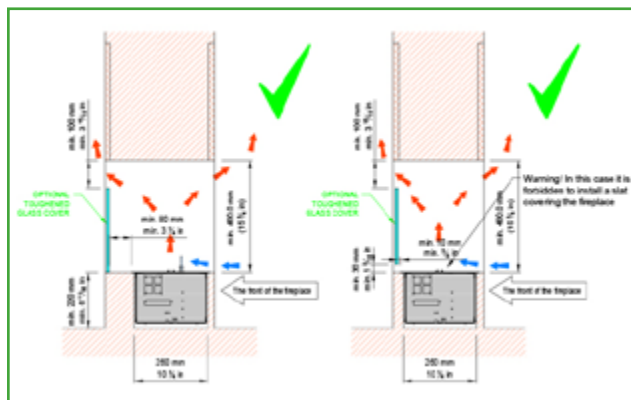
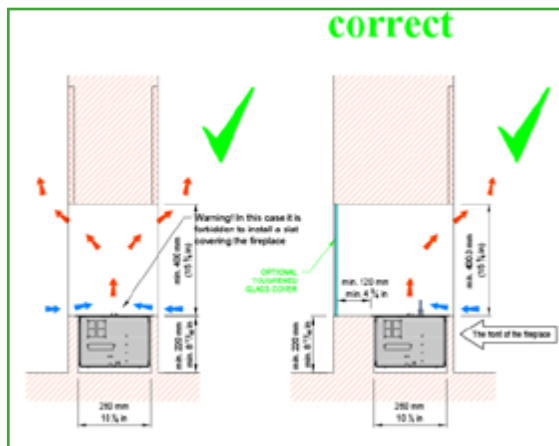

## Free-standing installation of the appliance

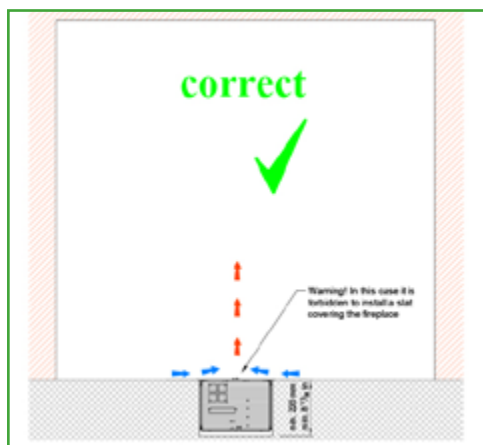
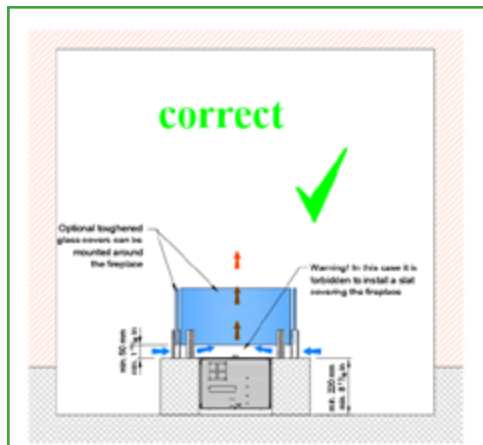
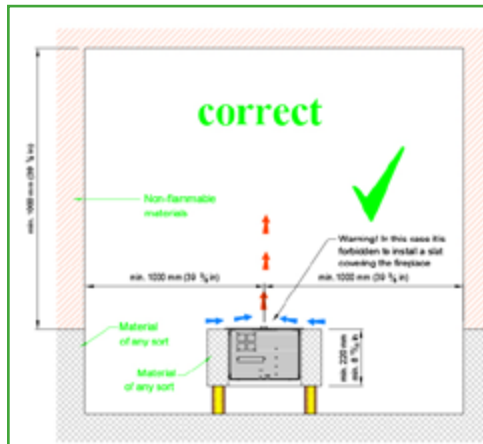

# Ventilation and air conditioning in the room in relation to installation of the appliance

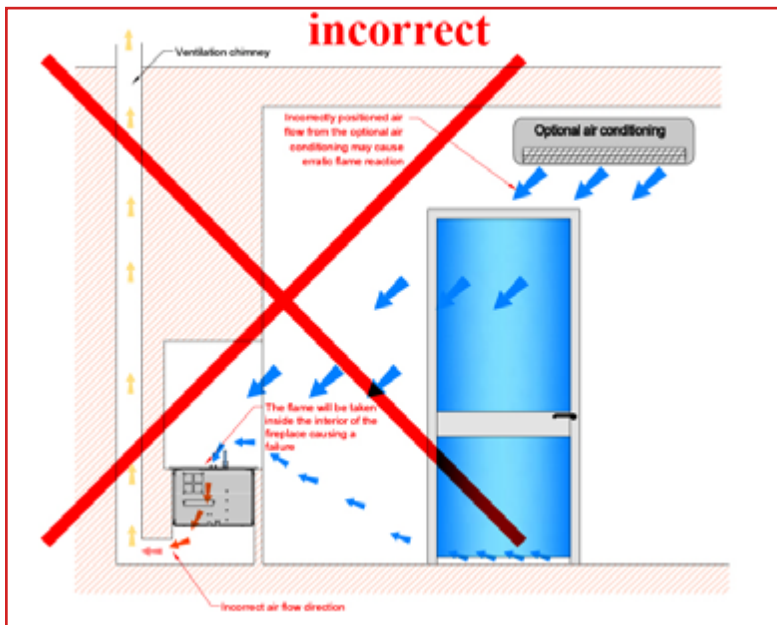
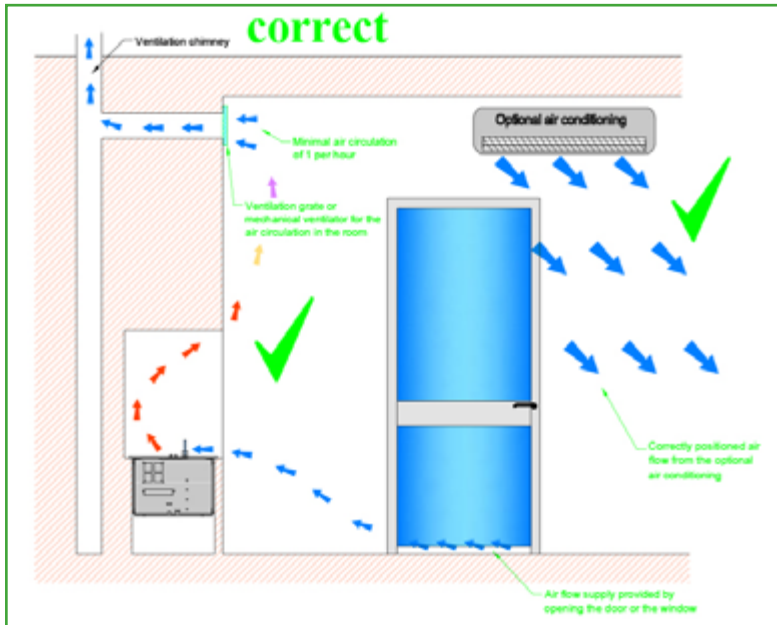

## Using an existing chimney flue

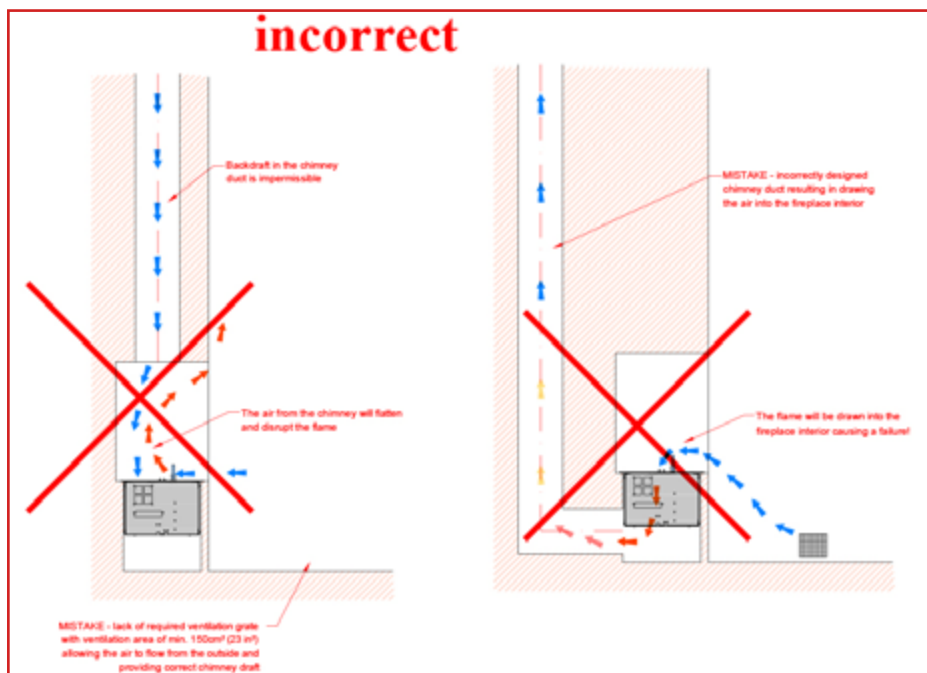
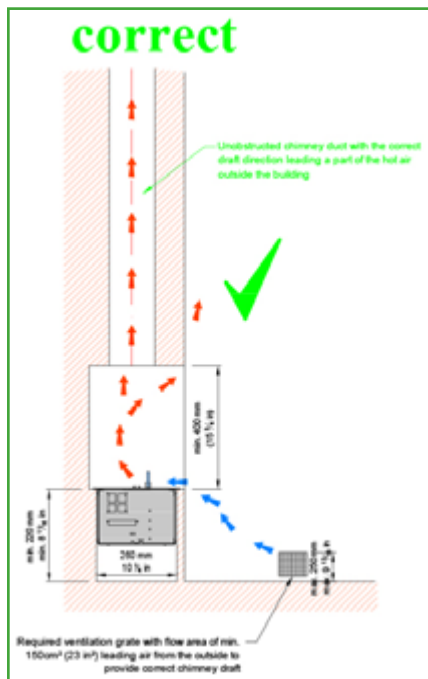

## Section B: User Manual

### I. Safety



This is a decorative appliance with real flames. In order to use the device properly and safely and in order to keep the warranty, the following safety rules should be observed. This is not a heating device.

- The device should be installed in accordance with to the installation manual.
- While working, the device emits heat, water vapour and carbon dioxide, therefore it is necessary for the appliance to only be installed in a room of appropriate cubic capacity and with adequate ventilation.
- During the start-up sequence of the device, the characteristic smell of the liquid used in the device may be perceptible.
- It is obligatory to have a carbon-dioxide or dry chemical extinguisher placed nearby the device.
- A device that is in operation on must not be moved. Wait for complete fuel burn-out, disconnect the power supply and cool down the elements before moving the device.
- The device should not be left without adult supervision.
- Prevent handling of the device by persons not trained in its use.
- Do not attempt to make changes or repairs to the construction of the device. Repairs can be made only by a person trained to service the device.
- Do not attempt to pour fuel into the device when lit as it may cause damage to the device and cause fire. Pouring fuel into a lit device may cause a sudden ignition and can cause fire, burns and a risk to life.
- Do not heat the fuel before starting-up the device.
- Do not start up the device if any fuel has been spilt.
- Do not cover a working device as it may cause fire.

- Keep the device and fuel away from children, pets and unauthorized persons.
- Bio-ethanol fuel is not suitable for consumption. Avoid contact with skin and eyes.
- Do not re-fuel when the device is lit.
- Do not tamper with the elements inside the device as this can cause burns, damage to the device or fire.
- Some elements of the device heat up to high temperatures. Do not touch areas of the device adjacent to the flames.
- Do not place any decorative elements on the burner's surface.
- **WARNING!** The glowing coil temperature heats up to 1300°C. Touching the device while it is turned on may cause burns.

• WARNING! Prior to moving the appliance burn the fuel out and move the appliance slowly, in the horizontal position, avoiding shaking. There is always some fuel left inside the device and if spilled the sensors might get wet. If that happens the appliance will not work until the liquid evaporates.

• WARNING! The first run can be made only after proper installation of the device and reading the manual instructions!

## II. Operation

The device is adjusted to work with Wi-Fi access (such as smartphone, tablet). If you are going to control the appliance by such means it is necessary to follow the instructions included in **Configuration of the module with Wi-Fi and Smart Home System**.

### Operating elements:

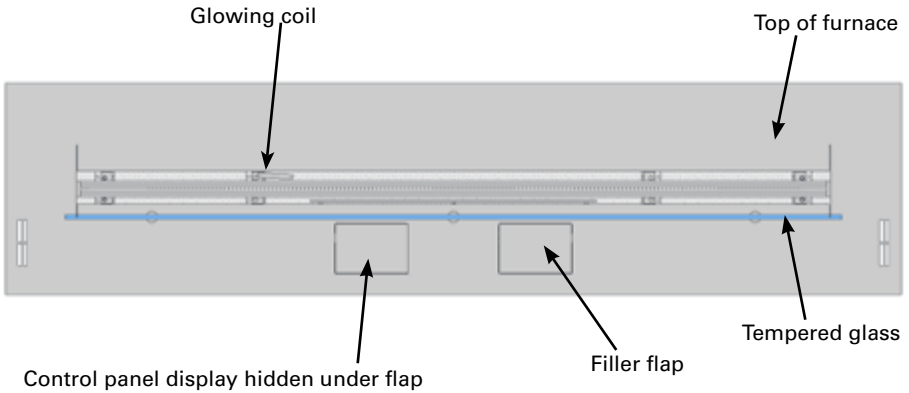

### Control Panel:

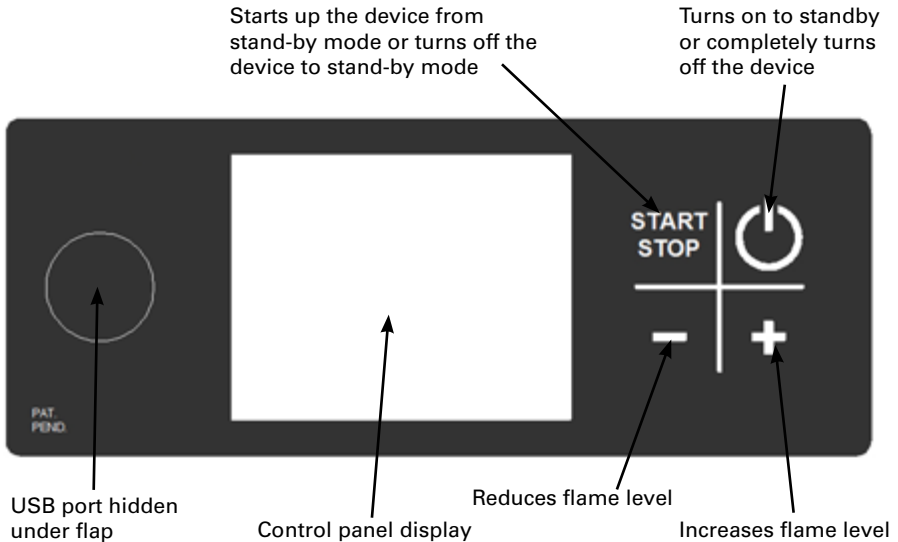



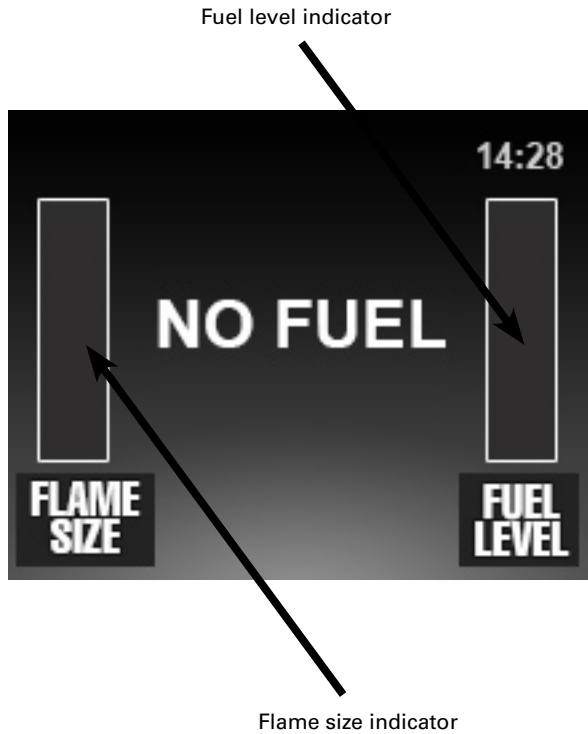

Control Panel Display:



### Initial Start-up of the Device:

1. If  button is flashing, the device is properly connected to the mains.
2. Press  button on the control panel. The welcoming display will appear and after 3 seconds you will see the message.

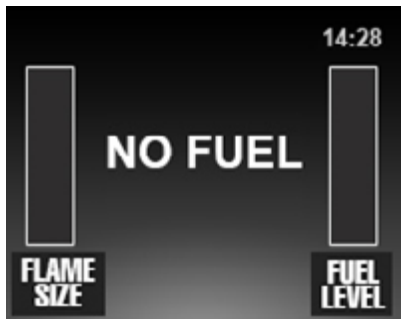

3. NO FUEL – lack of fuel. To fill it up:
  - 3a. Open the filler bolt, message will change to FILL WITH FUEL.

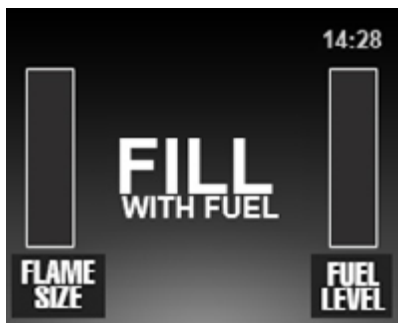
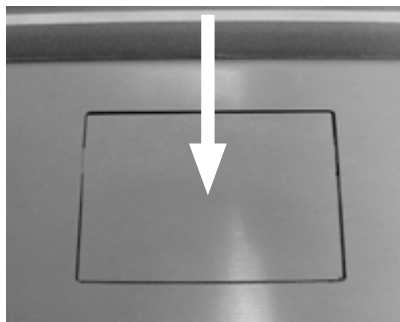

3b. Insert the funnel and fill the reservoir with fuel. Fuel level indicator on the display will increase.

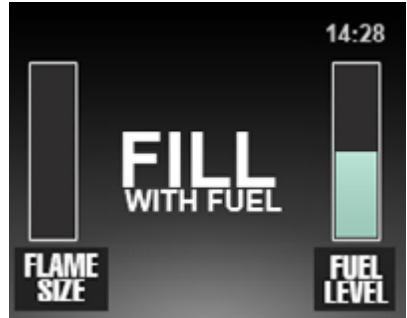



**ATTENTION!** Pour the fuel into the funnel **following these precautions:**

- During pouring be careful not to spill fuel out of the filler.
- If 5L containers are used to fill up, twist on the cap with the tap onto the container and pour the fuel using the funnel. To fill up only use accessories provided by the manufacturer.



WARNING! **ERROR 01** - the fuel has been spilt:

- stop filling the fuel instantly!
- remove the funnel
- dry the visible moisture
- with the use of the manual pump, supplied by the manufacturer, pump out at least 1 litre of fuel from the fuel filler
- close the filler flap
- **turn off the device with the red button** 
- **if the spillage is excessive the power supply needs to be disconnected**
- wait at least 1 hour until the remaining moisture evaporates
- after 1 hour turn the device on with the red button 
- if the ERROR 01 message appears, turn off the device and wait until the remaining moisture evaporates.

3c. When the message RESERVOIR FULL CLOSETHE LID appears on the display, stop pouring! Take the funnel out and close the filler flap.

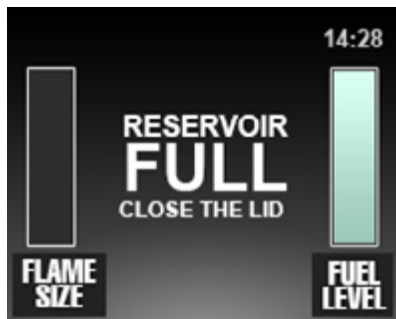

4. When message changes to READY – the appliance can be started:

- press the **START/STOP** button on the control panel or the **START** button on the remote control or on the configured appliance. **WARNING!** The glowing coil starts to heat up to 1300°C, when you touch it you may be burnt!

- If the function Child lock is turned on, you need to hold the **START/STOP** button on the control panel or **START** button on the remote control for 3 seconds. It is also possible to push **START** button on the configured appliance. **WARNING!** The filament starts to heat up to 1300°C, when you touch it you may be burnt!

5. PLEASE WAIT message – you need to wait a moment as it takes a few seconds for the appliance to ignite the flame.

6. WORKING message – the device is in working mode.



#### Flame size regulation:

- The appliance initially starts up at the 4th level of the flame size
- Adjust the flame size by pressing either the “+” or “-” button on the remote control, on the control panel or on the configured appliance.
- Flame size indicator displays the chosen flame size. There is also a number denoting the flame size visible above the flame size indicator.

### SLEEP function:

The appliance can be programmed to switch off after a given time. When the message WORKING is visible on the display, you need to hold “+” and “-” buttons simultaneously for a few seconds. The screen will appear:

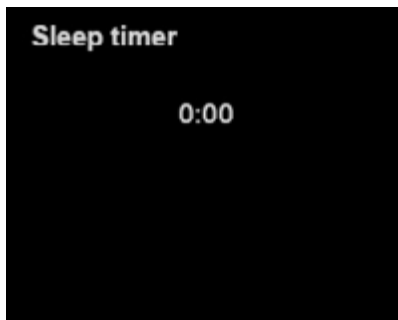

Using “+” button choose the desired time (not longer than 3 hours) and confirm with “-” button.

**WARNING!** The device with SLEEP function turned on cannot be left without supervision!

### Extinguishing the appliance:

Press the **START/STOP** button on the control panel or the **STOP** button on the remote control or on the configured appliance.

WORKING message will change into COOLING THE DEVICE – the device is too hot to be started again. To make the cooling process faster, the cooling fans start operating. When the device cools down the message on the display turns into READY.

### Subsequent start-up of the appliance:

NO FUEL message visible on the display - start the procedures as in point 3 of this manual.

READY message visible on the display - start the procedures as in point 4 of this manual.

## Switching off:

To switch off the device completely press the red button  on the control panel.

## **ATTENTION!**

The appliance will automatically stop working when:

- the fuel burns out (The “NO FUEL, REFUEL WHEN THE DEVICE IS COOLED” message will change to the “NO FUEL” message once the device cools down),
- the temperature of the appliance is too high, (COOLING THE DEVICE TEMPERATURE TOO HIGH message)

**INFO!** To avoid abrupt switching off when the temperature approaches critical level, the flame size will be diminished to 50% and will restrict the ability to increase the flame size – when you try to increase the flame size, the message will appear:

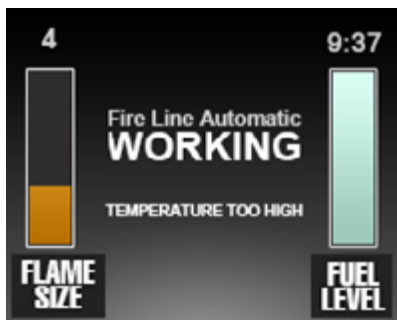

If the temperature of the device still increases, the device will switch off. When the temperature decreases to a safe level, flame size can be increased again.

- the device is moved or it senses seismic shocks (COOLING THE DEVICE. DEVICE HIT message)
- the device is tilted (COOLING THE DEVICE. DEVICE TILTED message)
- the allowed level of carbon dioxide is exceeded in the room (COOLING THE DEVICE CO<sub>2</sub> LEVEL TOO HIGH message)
- any occurrence takes place that evokes ERROR message

## Information and warning alerts:

<p>NO FUEL No message,</p>  <p>button is flashing</p>	<p>The device is connected to the mains, but remains dormant.</p>	<p>To start operating the device, press the red button on the control panel. In this mode, the device does not respond to commands sent from the remote control, the configured device nor buttons on the control panel.</p>
<p>READY</p>	<p>The device is connected to the mains and ready to start.</p>	<p>You can start from point 3 and refuel or from point 4 and immediately start the device.</p>
<p>NO FUEL</p>	<p>The fuel reservoir is empty.</p>	<p>Refill the fuel following the description in point 3 of the User's Manual.</p>
<p>NO FUEL, REFUEL WHEN THE DEVICE IS COOLED</p>	<p>The fuel has run out however the device is too hot to restart it.</p>	<p>Please wait until the device displays the NO FUEL message. Only then can the fuel be replenished in accordance with the point no.3 of the User's Manual</p>
<p>RESERVOIR FULL CLOSE THE LID</p>	<p>The fuel reservoir is full.</p>	<p>Close the filler bolt. You can start the device now.</p>
<p>FILL WITH FUEL</p>	<p>The filler bolt is open.</p>	<p>You can refill the fuel or close the bolt and start the device.</p>
<p>COOLING THE DEVICE</p>	<p>Protection against restart of the device when it is too hot.</p>	<p>Wait until the device cools down. The message will change to READY. When the message COOLING THE DEVICE is displayed, the fans that accelerate the cooling of the device switch on.</p>
<p>COOLING THE DEVICE TEMP. TOO HIGH</p>	<p>The acceptable device operation temperature has been exceeded.</p>	<p>Wait until the device cools down. The message will change to READY. When the message COOLING THE DEVICE is displayed, the fans that accelerate the cooling of the device switch on.</p>
<p>COOLING THE DEVICE DEVICE HIT</p>	<p>The device has been hit.</p>	<p>Wait until the device cools down. The message will change to READY. When the message COOLING THE DEVICE is displayed the fans that accelerate the cooling of the device switch on.</p>
<p>COOLING THE DEVICE DEVICE TILTED</p>	<p>The device has been tilted.</p>	<p>Wait until the device cools down. The message will change to READY. When the message COOLING THE DEVICE is displayed the fans that accelerate the cooling of the device switch on.</p>
<p>COOLING THE DEVICE CO<sub>2</sub> LEVEL TOO HIGH</p>	<p>The concentration of CO<sub>2</sub> has been exceeded.</p>	<p>Wait until CO<sub>2</sub> level in the room diminishes. It is advised to open the windows or open the door to adjacent rooms.</p>



ERROR 1	There was a fuel spill or leak detected.	Remove the funnel if it is placed in the fuel filler. Wipe visible moisture, pump out at least 1 litre of fuel using the attached manual pump then turn off the device using the red button on the control panel. <b>If the spillage is excessive the source of power needs to be disconnected.</b> Dry the visible moisture. Leave the device switched off for at least 1h. If the message is still displayed after restart, turn off the device for a longer time. If this does not solve the problem call SERVICE.
ERROR 2	An error of the heater temperature sensor.	Turn off the device using the red button on the control panel. Turn it on after a while. If the message does not disappear call SERVICE.
ERROR 3	An error of the fire temperature sensor.	
ERROR 4	An error of the reservoir temperature sensor.	
ERROR 5	Movement sensor actuated.	If the device was moved during operation. The message will disappear with the disappearance of the source of movement.
ERROR 6	An error of the fuel level probe.	Turn off the device using the red button on the control panel. Turn it on after a while. If the message does not disappear call SERVICE.
ERROR 10	The heater is damaged.	Turn off the device using the red button on the control panel. Turn it on after a while. If the message does not disappear call SERVICE.
ERROR 14	Limiting switch K2.	Call SERVICE.
ERROR 15	The device is tilted (set on a non-levelled surface).	Switch off the device using the red button on the control panel. Level the surface on which the device stands and restart the device.
ERROR 16	Exceeded temperature of the heater sensor.	Turn off the device using the red button on the control panel. Turn it on after a while. If the message does not disappear call SERVICE.
ERROR 17	Exceeded time of waiting for the appearance of flame.	
ERROR 20	Too low temperature in the hearth while turning on.	Turn off the device using the red button and try to restart the device.
ERROR 21	Too low temperature in the hearth during operation.	Turn off the device with the red button and wait until it cools down. Try to restart the device.

ERROR 31	Fuel spilled within fuel pump	Turn off the device with the red button and wait at least 1h. Try to restart the device. If the message does not disappear wait longer until the moisture evaporates completely. If the message does not disappear call SERVICE.
ERROR 98	Error occurred during remote control programming.	Try to program the remote control again.
ERROR 99	No connection between the control panel and microprocessor	Try to restart the device.. If the message does not disappear call SERVICE.

### III. Customer's Menu

If READY or NO FUEL message is visible on the display, you may access Customer's menu. To do this, hold "+" button for 8s and menu will appear on the display.

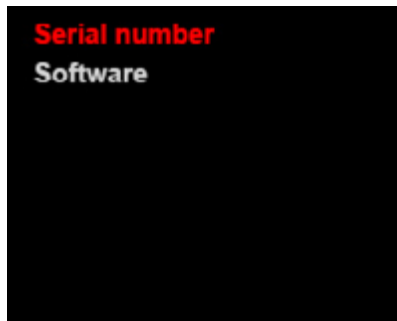
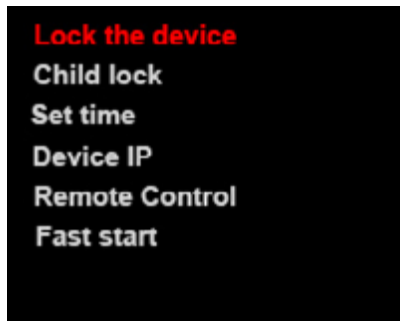

It is possible to operate the menu only by means of the buttons on the control panel. To move between the categories use "+" and to choose a particular category use '-'. Leaving the menu unused for 5s will result in coming back to the main display.

#### 1) Locking the appliance:

This function allows the device to be locked in order to avoid its use by unauthorized persons. To turn this function on press "-" on the control panel.

This screen appears:



The device cannot be turned on either via remote control, configured device or according to the manual, without previously unlocking it. To unlock the device hold **START/STOP** button for 5s – the message will disappear.

## 2) Child lock

When the function is turned on it forces the user to hold **START/STOP** button on the control panel or remote control for 3s in order to start the device. If **START/STOP** button is only pressed quickly, the device will not start.

To turn this function on press “-” on the control panel. This screen will appear:

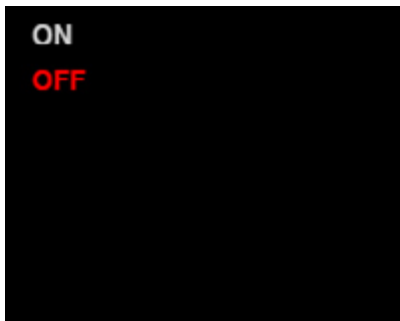

Using “-” button confirm **ON** option flashing in red. On the main display the information that ‘Child lock’ function is turned on will be visible.

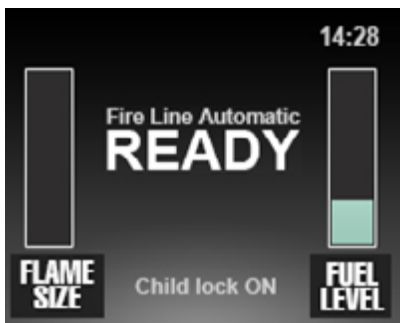

To turn this function off, choose **OFF** option in the menu of ‘Child lock’ function.

### 3) Set time

This allows date and time to be set.

Go to the menu's functions by means of "-" button. The hour starts to blink. Using "+" button set the appropriate hour and confirm with "-" button. Do the same to set minutes and date, using "+" for choosing the appropriate numbers and "-" for confirming them. When setting is finished, the device will automatically come back to the main display with time already visible.

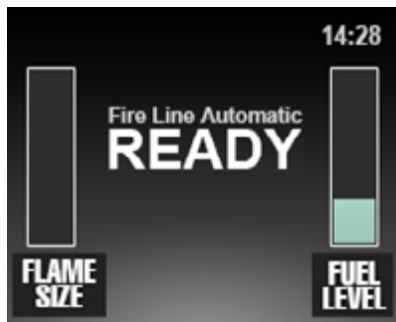

### 4) Device IP

This shows the device IP that is essential in operating the device via the configured appliance. Additional information can be found in the manual concerning [Configuration of the module with Wi-Fi and Smart Home System](#).

## 5) Remote Control

Remote control attached to the device is already programmed. This function allows for the remote control to be programmed if there is such a need at a future date or if one remote control is to control several units.

To program the remote control press "+"; choose 'Remote Control' and confirm with "-" button. This screen will appear:



Press "-" button to confirm. Then press in sequence (hold until next message appears) **START, STOP, PLUS, MINUS**. After the remote control has been programmed the messages disappear and main display appears. Remote control is programmed.

## 6) Fast start

When 'Fast start' function is turned on, the time for the flame to appear is much shorter. The device is automatically programmed with 'Fast start' function turned on. To turn it off press "-" button on the control panel. The screen will appear:

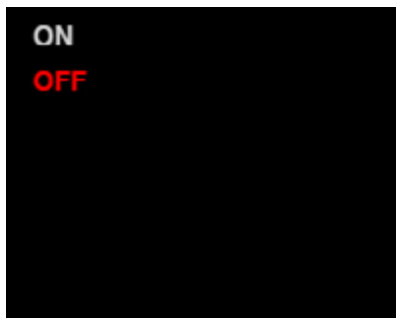

Using “+” button choose OFF option and confirm with “-” button. The device automatically returns to main display and ‘Fast start’ function will be turned off.

To restart this function choose ON option in menu of ‘Fast start’ function.

Warning! When ‘Fast start’ function is turned on the device uses 100W of energy.

Turning off the device with  button prevents from using the energy but does not turn off ‘Fast start’ function.

#### 7) Serial number

It displays serial number of the device.

#### 8) Software

It displays the version of an installed program.

## IV. Cleaning and Maintenance

Switch off the device before cleaning. Wait until the temperature of the device gets close to the ambient temperature. To maintain the device in good condition, please observe the following rules:



- To clean stainless steel surfaces, use only gentle cleaners which do not cause cracks or scratches, or use other means specifically designed for cleaning stainless steel.

The inside of the device can only be cleaned by a person competent to service the appliance.

The manufacturer does not foresee a situation where it will be necessary to clean elements not normally accessible.

The manufacturer is not liable for damage resulting from:

- Improper operation (failure to follow procedures detailed in the User's Manual).
- Self-dismantling of the device.
- Attempts to modify the device.
- Using other liquids than those recommended in point V. Fuel.



## **V. Fuel**

In order for the unit to function correctly only fuel must be used that is a 86-96% denatured ethanol in accordance with the European Union guidelines (Directive No. 162/2013).

Using other liquids is prohibited as it may lead to incorrect functioning of the device, damage of the device and/or may cause fire or and/or health risk. The manufacturer takes no responsibility for damage caused by using prohibited liquids such as absolute ethanol.

## **VI. Disposal and recycling**

The product is equipped with parts made of aluminium, steel, plastics and electronics. If you need to dispose of the device, follow the terms of disposal and recycling in force in your country.

Moreover, dispose of the empty fuel containers using appropriate plastic waste disposal.

Most of the materials used can be recycled.

If you have technical problems or other questions that require clarification, please contact the manufacturer.

## *Notes*



